



Edgemoor Close, Watersheddings

£219,950

🛏 2 🚿 1 🛋 2

- Semi Detached Home
- Two Double Bedrooms
- Fitted Wardrobes
- Beautiful Quality Finish
- High Spec Kitchen
- Conservatory
- Good Size Driveway
- EPC:



Offered for sale is this beautifully presented high specification two bedroom semi detached home located in this tucked away cul de sac. Viewing is highly recommended to appreciate the quality of this property. Accommodation comprising: Entrance hallway, lounge, kitchen/dining room and a conservatory. To the first floor are two double bedrooms and a well appointed bathroom. Externally there is a very easy maintenance garden and a driveway to the front. Easy reach for local motorway networks. Call us today to arrange a viewing. Edgemoor Close is found just off Ripponden Road. There are plenty of shops situated within just a very short walk as well as local primary schools. The amenities of Oldham town centre, including the Metro link service, are reachable within just a short drive. The picturesque Strinesdale Reservoir is also just a 10 minute walk away.



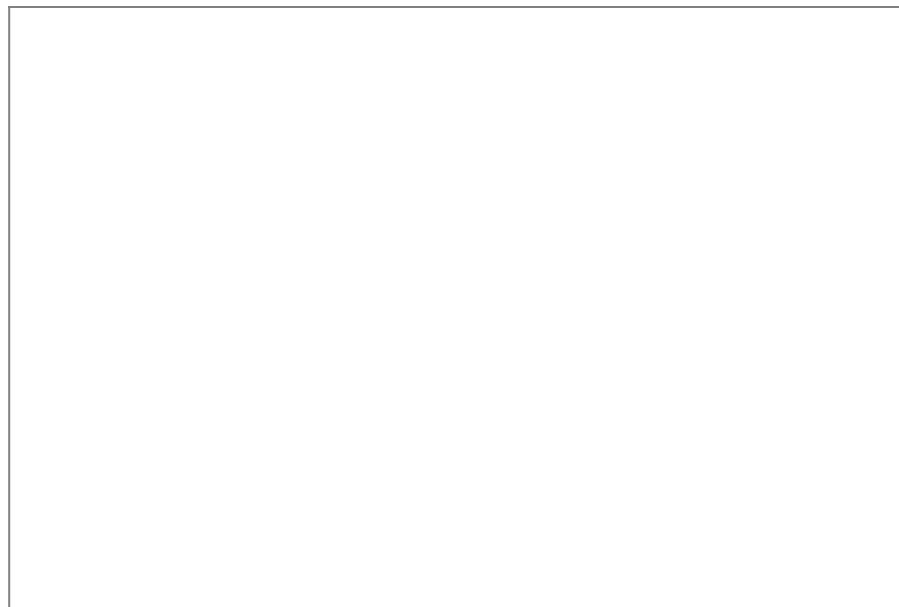
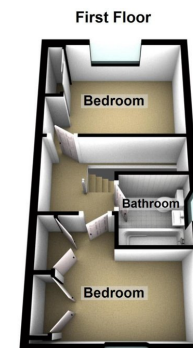
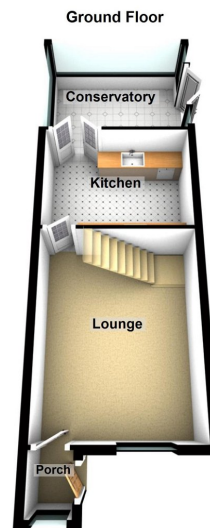

Chadderton Office

509 Middleton Road,
Chadderton, Oldham,
OL9 9SH

chadderton@kirkham-property.co.uk
t: 0161 626 5688